

Knurled/Barbed Retention Non Plated Through Hole Connectors with Ball Socket

[Key Characteristics

Functionality

- Self retaining interference fit
- For single & double sided PCBs
- Low insertion force
- Unique retention mechanism

Resilient

- Gold plated as standard
- Other finishes available: tin lead, palladium
- -55°C to +125°C

Adaptable

- Various lengths
- Bespoke designs available



The use of Snale Pins has been widely established in the commercial and military electronics market worldwide as the definitive terminal pin for use with non-plated through hole PCB's and chassis.

The Snaplox® concept enables highly accurate testing to be done whilst reducing the risk of board damage. This is due to the unique ball and socket arrangement which provides 8 points of low resistance contact through a 60° Connection angle.



[Technical Information

Pin	Brass with Gold Finish (option Tin Lead, Palladium)
Socket	Copper Alloy with Silver Finish & High Dispersion Grade PTFE
Solderability	Exceeds Requirements of BS2011 (IEC 68) Test T
Maximum Contact Resistance (with socket)	2 milliOhms
Socket Insulation Resistance	10,000 MegaOhms minimum
Typical Retention Force	2kg (Angles <30°) off perpendicular
Typical Retention Torque	200 gcm (Angles>30° or perpendicular)
Assembly Tools Socket Assembly - Line Plug	AT2/05 or ATS3/05, AT1/09 (Line Plug)
Assembly Tools Pin to PCB	AT1/09

[Series Information

Type No.	Mounting Hole Diameter	PCB Thickness	Shoulder diameter $\varnothing A$
030/SO/B2 or BF	0.81 mm (0.032") - 0.92 mm (0.036")	1.65 mm (0.065") - 1.85 mm (0.073")	1.6 mm (0.063")
030/SO/BF	0.81 mm (0.032") - 0.92 mm (0.036")	1.65 mm (0.065") - 1.85 mm (0.073")	1.6 mm (0.063")
030/SO/BCS/-	0.81 mm (0.032") - 0.92 mm (0.036")	1.65 mm (0.065") - 1.85 mm (0.073")	1.6 mm (0.063")
050/-	1.25 mm (0.049") - 1.40 mm (0.055")	1.4 mm (0.055") min	2.4 mm (0.094")
050/B2/RS	1.25 mm (0.049") - 1.37 mm (0.054")	N/A	2.4 mm (0.094")

[Part & Ordering Information

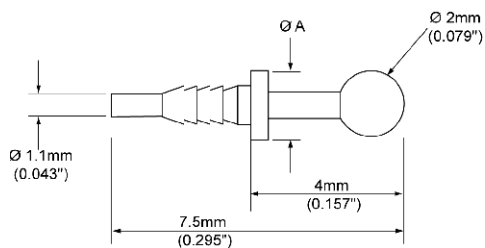

050/SOX/B2

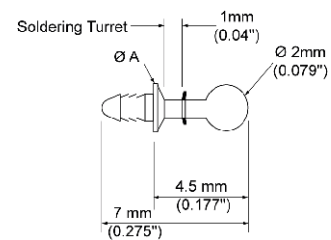

050/SO/BST

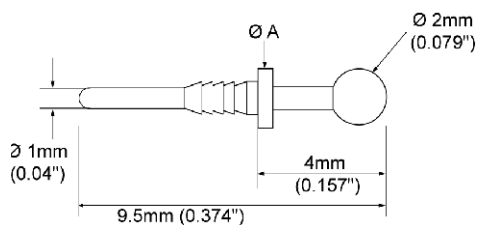

050/LT/B2

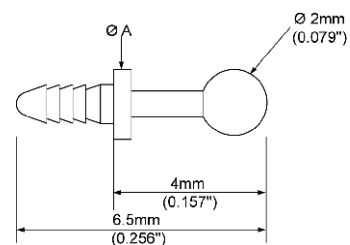

050/SO/B2

[Part & Ordering Information

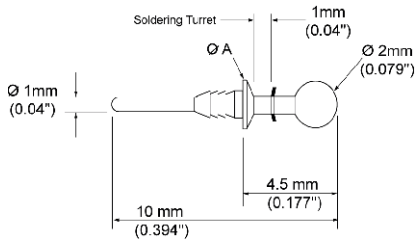

050/LT/BST

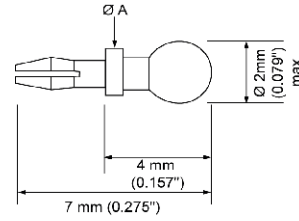

030/SO/BCS/P

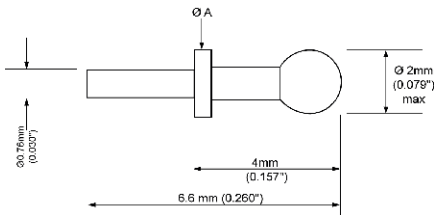

030/SO/B2

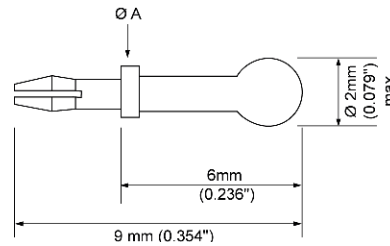

030/SO/BCS/F

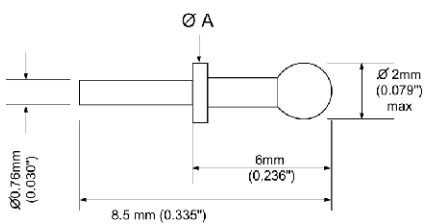

030/SO/BF

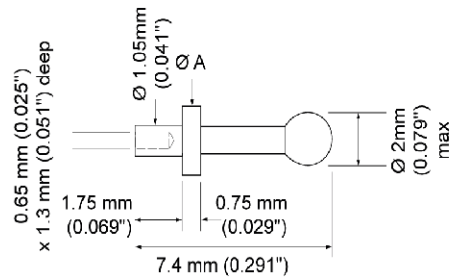

050/B2/RS

[Part & Ordering Information

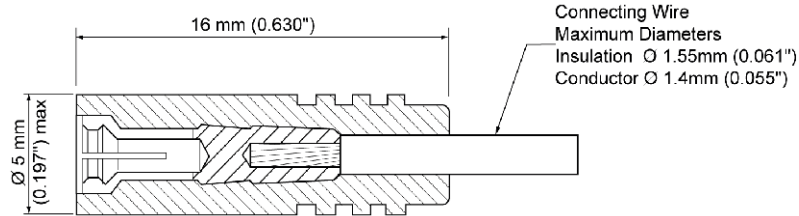

LS/B2/156

wire shown for illustration purposes only

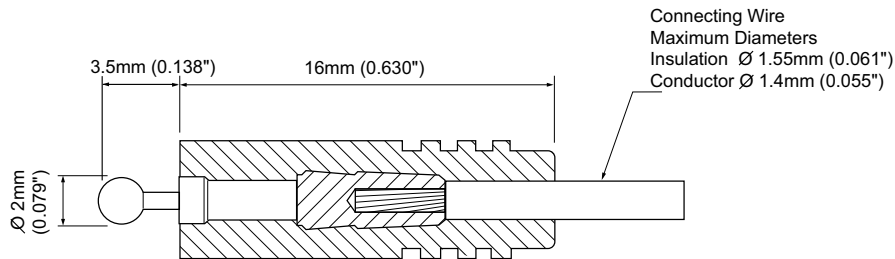

LP/B2/156

wire shown for illustration purposes only

