



GFP400

HIGH VOLTAGE BATTERY FAST DISCONNECT

A FAST AND PRECISE CIRCUIT PROTECTION SOLUTION FOR ADVANCED BATTERY SYSTEMS DURING SHORT CIRCUIT AND OVERCURRENT SITUATIONS

The high current levels and power densities in advanced battery systems demand equally high-performance safety components. Available in both passive and passive/active combinations, the GigaFuse from GIGAVAC, a brand of Sensata Technologies, is a fast-acting electromechanical device with low heat generation that allows for circuit trips at exact currents and features a design that easily pairs with contactors and eliminates thermal aging fatigue associated with typical DC fuses.

Highlights

- World-class automotive component supplier
- Application expertise, significant automotive knowledge base including quality and supply chain
- Global/Local approach, engineering, and commercial support
- Surety of supply: global manufacturing capability

Features

- Functional Safety: Passive technology with electro-mechanical release mechanism
- Fast disconnect: <3ms clear time independent from current level
- System protection coordination: tunable trip current to easily pair with HV contactors
- Optional active control: to provide designers flexibility of active/passive protection methods
- Up to 10MW interrupt capability
- 400A continuous current carry (4/0 busbars); Consult engineering for higher current

Applications



GFP400 Technical Specifications

Dimensions are in [inches] millimeters
Tolerance is +/- 1mm for all dimensions, unless stated otherwise.

Dimensions and tolerances shown are derived from the product envelope drawing – contact Sensata to confirm any values when designing into specific applications.¹⁰

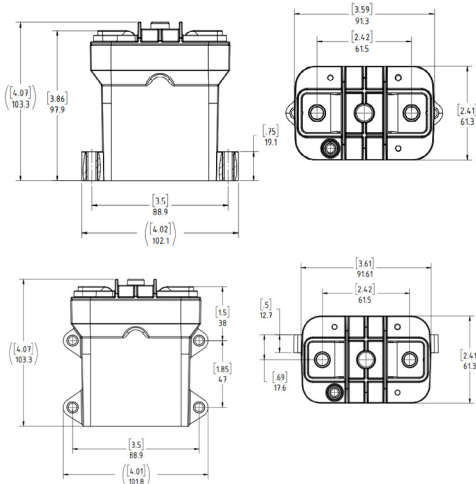

Specifications	Units	Data
Rated Voltage	V	1000
Continuous Current Rating ²	A	400
Maximum Breaking Power ³	MW	10
Fault Clear Time at 10MW ⁴	ms	3
Device Resistance, beginning of life	mΩ	< 0.15
Trip Tolerance	A	+100 / -400
Insulation Resistance After Interrupt (1000VDC) ⁴	MΩ	≥0.5
Operating Temperature (Ambient) ⁵	°C	-40 to +85
Allowed Terminal Temperature Maximum ⁶	°C	150
Trip Sensitivity to Mechanical Shock ⁷		50G powered 100G unpowered
Vibration ⁸		5G RMS Sinusoidal, 12hr/axis, 10-2000Hz, 400A continuous
Mass	g	750, Passive, 790, Active

Mounting

M5 or No. 10 Screws
Torque 1.7 - 4 Nm [15-35in-lb]

Case Material

Thermoplastic Polyamide Resin

Power Connection

M8 x 1.25 Female
Torque 12-18 Nm [106-159 in-lb]

Pyro Connection

Refer to TE Instruction Sheet 411-78033 for additional connector details.
Qualified Acc. to LV 16 and USCAR
Initiator Resistance: ≥1.7Ω and ≤2.5Ω
Triggering Pulse Current: ≥1.75A / 0.5ms
≥1.2A / 2.0ms
Diagnostic Current: ≤100mA
No Trigger Current: ≤0.4A or ≤5.0A / 4μs
Color of connector retainer may vary due to supply availability

MOMENTARY CURRENT CURVE

80°C terminal temperature rise at specified curve

Momentary Carry Current vs Time (70°C Ambient, 105mm² busbars)

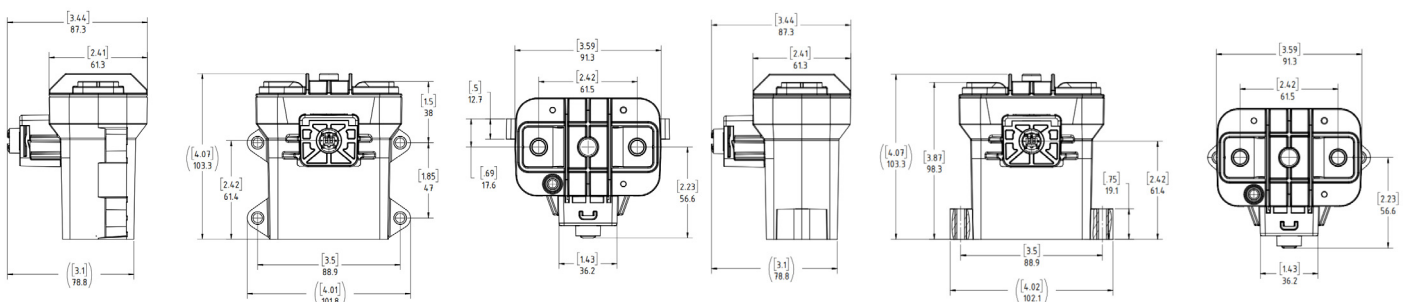
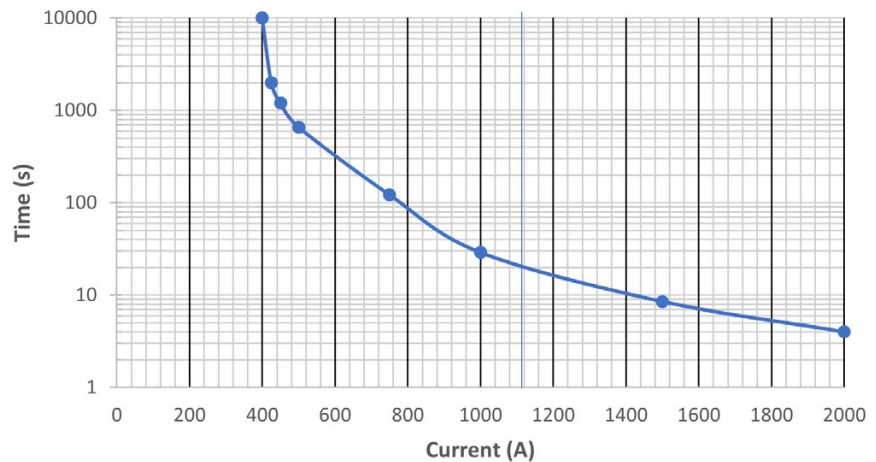

GFP400 Technical Specifications

Ordering Options

Example: GFP(A)4 **15B**

Family
GFP400

Active Function

Optional A: (in production for 1500A trip level, contact engineering for active function at other trip levels)

Trip Trigger Current

15: 1500A
20: 2000A
22: 2200A
25: 2500A

Orientation

Upright: A
Side Mount: B

General Notes

1. For customers who can accommodate a vented device, contact Sensata Technologies for more information.
2. Current rating (both continuous and momentary) is dependent on bus bar size and customer specific application conditions. Consult with Sensata Technologies for specific details.
3. Performance in application will vary based on customer environment and system isolation requirements. Validated at following conditions: 650 V, 15.5kA, 12 μ H system inductance. Up to 850 V, 12kA, with 4 μ H system inductance. For 1000V application above 3kA, contact Sensata engineering
4. Clear time below 5kA can reach up to 4 ms max. IR after 8MW interrupt $>1M\Omega$
5. Insulation resistance is dependent on power level of max interrupt load and IR increases with reduced power levels or lower system inductance. IR after standalone short circuit may be below 0.5M at system inductance over 4uH. Performance when tested at system level will show improved IR post interrupt.
6. Device can operate in higher ambient temperatures with derated current carry while below maximum terminal temperature.
7. Measured on top of the bus bar at the bolted joint. Customer is responsible for ensuring this condition is met otherwise damage to device can occur.
8. Sensata Technologies recommends orienting Z axis orthogonal to any mechanical shock pulses to ensure robust performance under load. Sensitivity is dependent on trip setting, consult with Sensata Technologies for more details. See photo for axis orientation.
9. Performance depends on specific vibration profile and trip level, consult with Sensata Technologies for your specific requirements.
10. For Automotive Applications please request technical workshop with Sensata Technologies Application Engineering.

RISK OF MATERIAL DAMAGE AND HOT ENCLOSURE



- The product's side panels may be hot, allow the product to cool before touching
 - Follow proper mounting instructions including torque values
 - Do not allow liquids or foreign objects to enter this product
- Failure to follow these instructions can result in serious injury, or equipment damage.



Hazard of electric shock, explosion or arc flash

- Disconnect all power before installing or working with this equipment
 - Verify all connections and replace all covers before turning on power
- Failure to follow these instructions can result in death or serious injury.



STRONG MAGNETS PRESENT

- This device may present a risk to people with pacemakers if brought within 5 inches (125mm) of device
- This device may present a risk to computer drives or other magnetic sensitive electronics or attract small metal tools within 4 inches (100mm) of the device.

Failure to follow these instructions can result in death or serious injury.

Datasheets provided by Sensata Technologies, Inc., its subsidiaries and/or affiliates ("Sensata") are solely intended to assist third parties ("Buyers") who are developing systems that incorporate Sensata products (also referred to herein as "components"). Buyer understands and agrees that Buyer remains responsible for using its independent analysis, valuation, and judgment in designing Buyer's systems and products. Sensata datasheets have been created using standard laboratory conditions and engineering practices. Sensata has not conducted any testing other than that specifically described in the published documentation for a particular datasheet. Sensata may make corrections, enhancements, improvements, and other changes to its datasheets or components without notice. Buyers are authorized to use Sensata datasheets with the Sensata component(s) identified in each particular datasheet. HOWEVER, NO OTHER LICENSE, EXPRESS OR IMPLIED, BY ESTOPPEL OR OTHERWISE TO ANY OTHER SENSATA INTELLECTUAL PROPERTY RIGHT, AND NO LICENSE TO ANY THIRD PARTY TECHNOLOGY OR INTELLECTUAL PROPERTY RIGHT, IS GRANTED HEREIN. SENSATA DATASHEETS ARE PROVIDED "AS IS". SENSATA MAKES NO WARRANTIES OR REPRESENTATIONS WITH REGARD TO THE DATASHEETS OR USE OF THE DATASHEETS, EXPRESS, IMPLIED, OR STATUTORY, INCLUDING ACCURACY OR COMPLETENESS. SENSATA DISCLAIMS ANY WARRANTY OF TITLE AND ANY IMPLIED WARRANTIES OF MERCHANTABILITY, FITNESS FOR A PARTICULAR PURPOSE, QUIET ENJOYMENT, QUIET POSSESSION, AND NON-INFRINGEMENT OF ANY THIRD PARTY INTELLECTUAL PROPERTY RIGHTS WITH REGARD TO SENSATA DATASHEETS OR USE THEREOF. All products are sold subject to Sensata's terms and conditions of sale supplied at www.sensata.com. SENSATA ASSUMES NO LIABILITY FOR APPLICATIONS ASSISTANCE OR THE DESIGN OF BUYERS' PRODUCTS. BUYER ACKNOWLEDGES AND AGREES THAT IT IS SOLELY RESPONSIBLE FOR COMPLIANCE WITH ALL LEGAL, REGULATORY, AND SAFETY-RELATED REQUIREMENTS CONCERNING ITS PRODUCTS, AND ANY USE OF SENSATA COMPONENTS IN ITS APPLICATIONS, NOTWITHSTANDING ANY APPLICATIONS-RELATED INFORMATION OR SUPPORT THAT MAY BE PROVIDED BY SENSATA. Mailing Address: Sensata Technologies, Inc., 529 Pleasant Street, Attleboro, MA 02703, USA

Copyright © 2025 Sensata Technologies, Inc.

rev.01/25/2025

Regional head offices:
United States of America
Sensata Technologies
Attleboro, MA
Phone: 508-236-3800
E-mail: support@sensata.com

Denmark
Sensata Technologies
Denmark A/S
Greater Copenhagen
Phone: +45 5851 5104
Email: lb_contact@sensata.com

Netherlands
Sensata Technologies
Holland B.V.
Hengelo
Phone: +31 74 357 8000
E-mail: support@sensata.com

China
Sensata Technologies China
Co., Ltd.
Shanghai
Phone: +8621 2306 1500
E-mail: support@sensata.com

sensata.com